

A

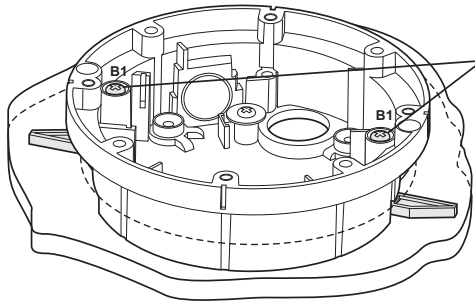

B

Turn silver-colored screws clockwise to first extend the locking arms and then tighten them against the mounting surface. Tighten the screws sufficiently to compress the o-ring moisture seals located underneath the screwheads, however: **DO NOT OVERTIGHTEN.**

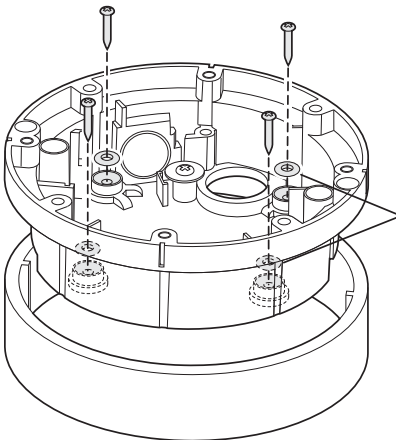

C

Rubber o-rings to maintain moisture seal when fixing externally.

Polycarbonate Vandal Dome

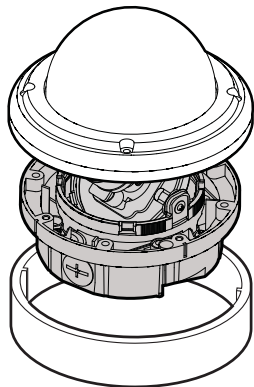

INSTALLATION GUIDE

Precautions

- Do not attempt to dismantle the camera module mounted within the dome. There are no user serviceable parts within the camera module. Refer servicing to qualified personnel.
- Handle the camera with care. Do not abuse the camera. Avoid striking or shaking it. Improper handling and storage could damage the camera.
- Do not operate the camera beyond its temperature, humidity or power source rating. Please refer to the environmental information provided overleaf.

Methods for mounting the enclosure

There are three main ways to mount and fix the dome enclosure:

- A: Flush mount using screws
 - B: Flush mount using locking arms
 - C: Surface mount using the outer ring
- Note: Always use the template provided

When mounting externally

When mounting externally using the four base holes, use the supplied rubber o-rings (Shown in C) within the mounting holes to ensure a moisture resistance seal. Ensure the cable entry through either knockout panels is suitably sealed against moisture ingress. Regardless of whether the locking arms are used for installation or folded away (in favor of another installation method), always insure the locking arms screws are tight enough to compress the rubber o-rings to maintain the moisture seal.

Packing list

In addition to the installation sheet:

- 1 x Dome Enclosure
- 4 x #12 x 1 1/2 mounting screws
- 4 x Rubber sealing o-rings
- 4 x Wall plugs
- 1 x Torx key bit
- 1 x wire ended power adaptor lead
- 1 x Large rubber gasket (fitted between enclosure and outer ring)
- 1 x 3/4" sealing plug (1/2" sealing plug fitted to enclosure)
- 1 x 1/2" and 1 x 3/4" cable entry grommets

Weather resistance

IP66 Rated

Emissions

FCC COMPLIANCE: This equipment complies with Part 15 of the FCC rules for intentional radiators and Class B digital devices when installed and used in accordance with the instruction manual.

Following these rules provides reasonable protection against harmful interference from equipment operated in a commercial area. This equipment should not be installed in a residential area as it can radiate radio frequency energy that could interfere with radio communications, a situation the user would have to fix at their own expense.

Power supply requirements

12VDC or 24VAC 4 watts

Please visit our website for more information:
www.devieurope.com

VDP20 / V531-DC000-S00
Ver. 12/2007

Template

Flush mount

Create an aperture in the mounting surface to a diameter of 4.3"(110mm) as indicated by "T5".

Using locking arms: Place the enclosure (with the locking arms retracted) into the opening. Use a cross-head screwdriver to rotate the screws B1 (shown in fig B) until the locking arms, firstly splay out, and then tighten against the inner face of the mounting surface. Tighten the screws sufficiently to compress the o-ring moisture seals located underneath the screwheads, however: **DO NOT OVERTIGHTEN.**

Using screws: Create two holes at template positions "T2" of diameter 3/4"(7mm) and insert a wall plug into each.

Use 2 x (no. 12 x 1 1/2") screws.

Surface mount

Create four holes of diameter 3/4"(7mm) at template positions "T1". Use 4 x wall plugs and 4 x (no. 12 x 1 1/2") screws. When mounting externally, use a rubber o-ring at each mounting hole in the base to ensure moisture resistant seals.

Cable entry (in all cases)

Use either the base cable entry "T3" or the side cable entry "T4" also shown in fig E overleaf. Both cable entries are threaded for use with locking collars (threads are 3/8" NPT on the base and 1/2" NPT on the side knockout).

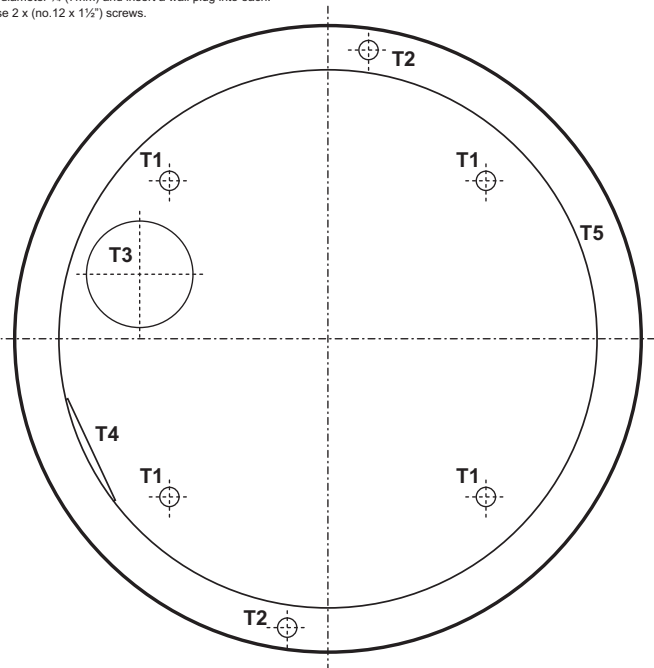

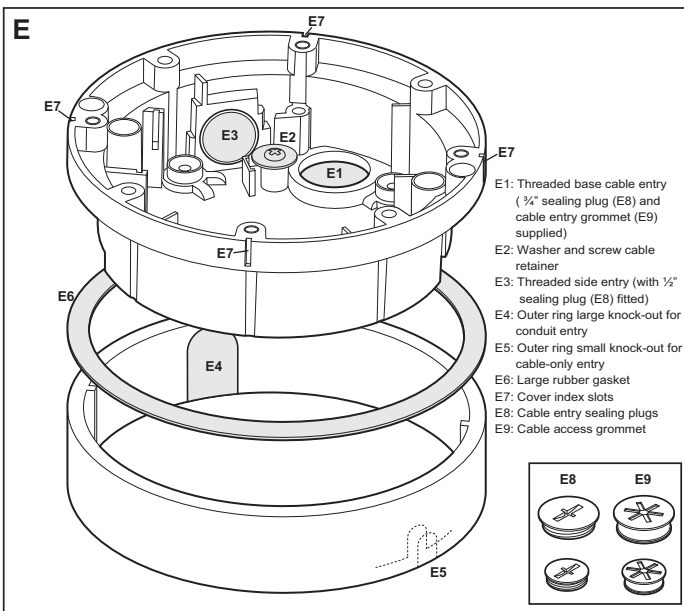

Installing the dome enclosure

1 Remove the dome cover

Use the supplied Torx driver to loosen (but not remove) the four cover screws. The screws are captive and will be retained in the lid.

2 Use the template to mark-out and prepare the mounting area

The WDR Camera was designed to maintain its IP and NEMA ratings independent of the install method chosen. Therefore, all mounting access positions are sealed until they are ready to be used. For example when surface-mounting the housing, first knock out the screw access holes that correspond to the template marks "T1". This can be accomplished by using a cross-point screwdriver.

3 Open the required cable entry

Use either the base cable entry (E1) or side cable entry (E3) as required. When surface mounting and using the side cable entry (E3) open either the large (E4) or small (E5) knock-out within the outer ring to the required size by cutting away excess material with a hole cutter, sharp knife or side cutters. The outer ring can be rotated so that either of the knock-outs lie alongside the side cable entry, as required. Unused cable entries should be blanked with sealing plugs (E8). If the conduit entry is not used, cables should be passed through a slotted cable grommet (E9) to prevent dust ingress. For external applications, conduit should be used to carry cables into the housing.

4 Mount the dome enclosure

Using one of the mounting schemes discussed overleaf (Methods for mounting the enclosure), fix the dome enclosure (and outer ring, if necessary) in place. When flush mounting or surface mounting using the outer ring, ensure that the large rubber gasket (E6) is in place under the lip of the dome enclosure. **IMPORTANT:** If the dome is being mounted externally using the four base holes, use the supplied rubber o-rings within each of the four mounting holes of the dome base to ensure moisture resistant seals (see fig C overleaf).

5 Connect the wiring

Feed the preconnected main lead (that terminates in the connections F1 and F2) through one of the cable access points and connect it to your video out and power in cables.

A wire-ended adaptor lead (F8) is supplied for use with power supply cables that are not terminated with an appropriate power connector (For 12VDC operation: Connect the red lead to +ve and the black lead to -ve. For 24VAC connection, polarity is not important).

A service jack socket (F3) is also provided for temporary video connection when focussing the camera, using an optional (SVC-CABLE) service lead.

IMPORTANT: The power supply must be Class 2 certified.

IMPORTANT: If the dome is being mounted externally, use a suitable sealant around the cable entry hole to ensure a moisture resistant seal.

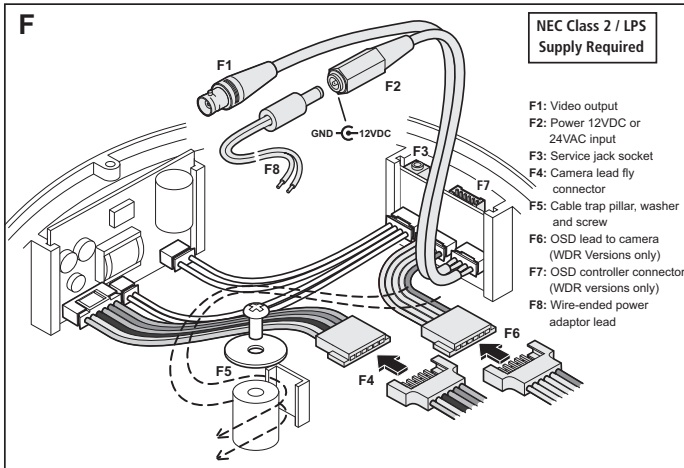
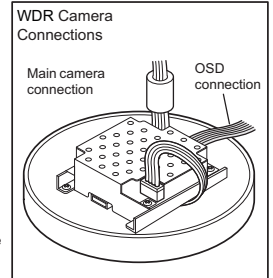

6 Fit the camera assembly

Connect the camera to the fly-connector (F4). For WDR version cameras - replace the 6 wire split lead connector that is plugged into the power supply (F4) with the 5 wire split lead connector that ships with the camera also connect the OSD lead (F6) between the camera and the middle socket of the smaller circuit board.

Place the complete camera assembly (G1) onto the three mounting pillars (G3) within the enclosure.

7 Remove the camera liner

Lift the camera liner (H1) from the chassis (H2) to provide full access to the camera.

8 Adjust the camera position and test

Rotate and pan the camera chassis to the required position and then tighten the camera chassis locking screws.

Note: For specific camera adjustments (i.e. focussing and settings), please refer to the camera sheet.

9 Replace the camera liner

Carefully fit the camera liner (J1) over the focussed camera so that it locates fully on the top ring of the camera chassis (J2) and provides an unobstructed view for the camera lens.

10 Replace the dome cover

Replace the dome cover (four small internal ribs within the cover locate within four corresponding index slots (E7) within the enclosure body - these restrict the lid to only four possible orientations and ensure that the cover screw holes are correctly aligned). Use the supplied Torx key to tighten the four cover screws. **DO NOT OVERTIGHTEN.**

