

INSTRUCTION MANUAL

DOME COLOUR CAMERA

D410-TP22H33V12LWDR



About this manual:

Before installing and using the camera, please read this manual carefully. Be sure to keep it handy for later reference.

PRECAUTIONS

- Do not open or modify
Do not open the case except during maintenance and installation, as it may be dangerous and cause damage.
- Do not put objects inside the unit
Make sure that no metal objects or flammable substances get inside the camera. It could cause fire, short-circuits or damage.
- Be careful when handling the unit
To prevent damage, do not drop the camera or subject it to strong shock or vibration.
- Install away from electric or magnetic fields
- Protect from humidity and dust
- Protect from high temperature
Be careful when installing close to the ceiling, in a kitchen or boiler room, as the temperature may rise to high levels.
- Cleaning
Dirt can be removed from the case only by wiping it with a soft cloth moistened with a soft detergent solution.
- Mounting Surface
The mounting surface material must be strong enough to support the camera.
- Ingress Protection
Ensure all cable entry points are sealed with silicone sealant to prevent moisture ingress.

TROUBLESHOOTING

Before sending the camera out for repair, check the items below. If the problem persists after checking these items, contact your service center.

■ If no image appears

- Is the coaxial cable attached securely?
- Are the power and voltage normal?
- Has the iris of the lens inside the camera been adjusted correctly (with the level volume) ?
- Is there adequate illumination?

■ If the image is unclear

- Is the lens in focus?
- Is the lens dirty?
Dirt or fingerprints on the lens can adversely affect the images. Gently wipe any dirt or fingerprints off the lens with a soft cloth or lens cleaning paper and cleaning fluid (commercially available).
- Is the monitor adjusted correctly?

WARNING:

TO PREVENT THE RISK OF FIRE OR ELECTRIC SHOCK, DO NOT EXPOSE THIS APPLIANCE TO RAIN OR MOISTURE.

SPECIFICATION

Model No.	D410-TP22H33V12LWDR
Sensor	1/3" CMOS (Wide Dynamic Range sensor)
H.Resolution	480
Scanning system	525 Lines interlaced (NTSC) 625 Lines interlaced (PAL)
Video output	Composite (1.0Vp-p), 75Ω
Synchronization	Internal / Line Lock
Electronics iris	1/60 ~ 1/100,000 (NTSC) 1/50 ~ 1/100,000 (PAL)
Light sensitivity	0.08Lux (DSS on) with F1.2 50IRE
Gamma	0.45
S/N Ratio	48dB
Input voltage	DC10-20[V], AC20-28[V]
OSD Control	OSD Control
Power consumption	MAX 8.0[W]
Operating temperature	-10℃ ~ +55℃
Storage temperature	-20℃ ~ +70℃
Operating Humidity	90% RH (non-condensing)
Connection (Video)	BNC Cable
Connection (Power)	Wire Type
Certification	CE/FCC

DIMENSION (mm)

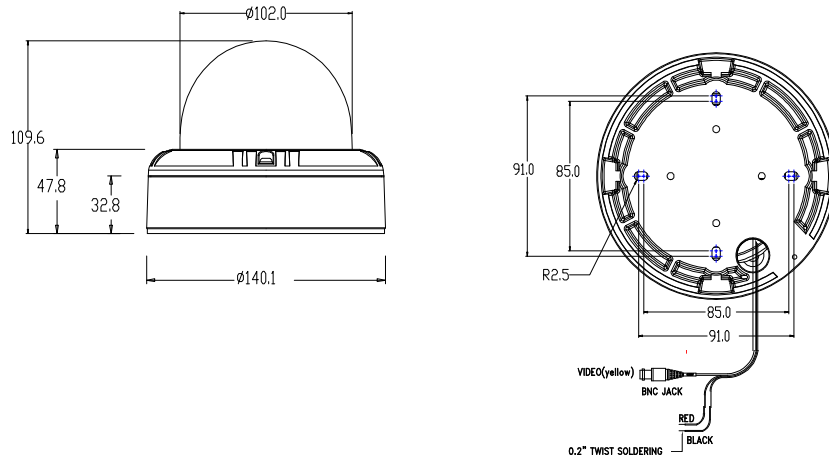

LENS ADJUSTMENT

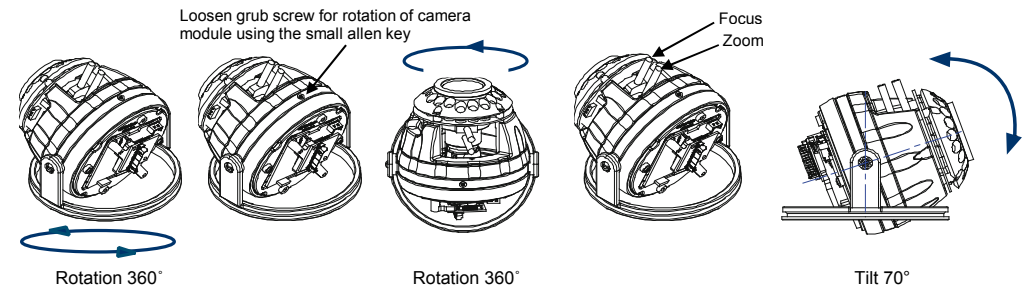

1. Adjust the panning(360°), rotation (360°) and tilt(70°) position.
2. Set the zoom position using the Zoom Lever Screw.
3. Set the focus using the Focus Lever Screw.

CAMERA SETTINGS

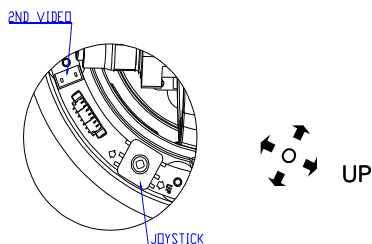

■ OSD MENU CONTROL

• CENTER KEY – Used to access menu mode, Also used

to confirm the setting

• UP/DOWN KEY – Used to choose the desired menu selection.

• LEFT/RIGHT KEY – Used to choose the desired menu feature adjustment.

■ OSD MENU ENTER/EXIT

A. OSD MENU ENTER

1. Press the SET key for 3 seconds to access the main setup mode.
2. Select the desired feature using the UP or Down key.
3. Change the status of the selected feature using the LEFT or RIGHT key.

B. OSD MENU EXIT

- Press EXIT Menu from Main Menu
- The "SAVE NEW AND EXIT" option must be used to save changes made to the camera setup
- If the Set Key is pressed for 3 seconds from Main Menu the menu will close, however changes will not be saved.

■ MAIN MENU

A. SETUP ID

- DISPLAY ID
 - ON : The ID name will displayed in the monitor.
 - OFF : The name will not displayed in the monitor.
- CAMERA ID : Up to a total of 12 characters may be defined.
- ID POSITION : Select on screen position of the camera ID.

B. LENS

- MANUAL : Use When using Manual lens.
- DC : You can control the brightness of the screen and adjust the desired DC level from 10 to -42.

C. WDR

- EXPO(EXPOSURE): It has the effect of lightening or darkening the picture
- WDR (Wide Dynamic Range) : You can adjust the desired WDR level from 20 to -20.

D. WB CONTROL

- ATW (Auto Tracking White Balance) : The camera automatically controls the white balance in any environment.
- AWB (Auto White Balance) : The white balance is automatically adjusted in a specific environment. Press the set key to fix the White Balance.
- MANUAL : Users can adjust the colour balance by adjusting the R/B gain. You can adjust the desired WB colour temperature from 2,500K to 9,500K

E. AGC

- ON : Activate automatic gain control feature. You can adjust the desired AGC level from 0 to 38dB.
- OFF : Deactivate automatic gain control feature.

F. LOW LIGHT

- SLOW SHUTTER : Control Image brightness by adjusting shutter speed
 - AGC : shutter speed setting (Range 28 to 48)
 - MAX FIELD : Shutter open from Min. x2 to Max. x32 field accumulation period.
- B&W SS (Black and White Slow Shutter)
- GAIN : To get brighter picture.

G. SYNC

- INTERNAL : Internal synchronization
- LINE LOCK : Phase adjustment may be necessary in multiple camera installations to prevent picture roll when switching between cameras (24VAC supply only)

H. DAY/NIGHT

- AUTO : For automatic switchover from day mode to night (Note : This setting is dependent on the AGC setting.)
- B/W : To keep a B/W image at all times
- COLOR : To keep a color image at all times

I. EXIT MENU

- EXIT NO CHANGES : No change
- SAVE NEW AND EXIT : Save change
- RESTORE FACTORY SETTINGS : Factory default
- SW REV

J. PREVIOUS PAGE

- PREVIOUS PAGE : Return page

INSTALLATION & CONNECTION

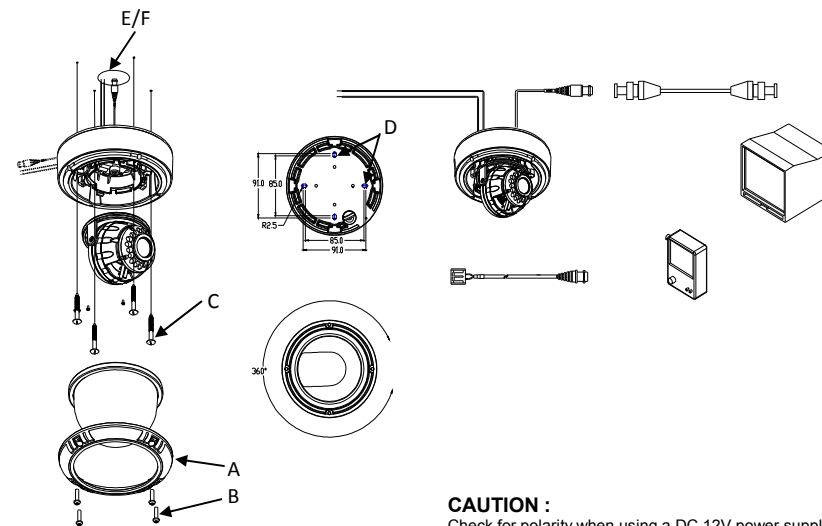

CAUTION :
Check for polarity when using a DC 12V power supply.

1. Use the supplied L-wrench to remove the four fixing screws (B) of dome cover (A).
2. Align the camera unit with the surface of the ceiling, make marks on the ceiling in the places where the screw holes are to be drilled, and then drill the four holes.
3. Cut a hole (diameter 2.9in.73mm) in the ceiling for routing the cables.
4. Pass the power cable (E) and video cable (F) from the camera unit through the cable hole in the ceiling.
5. Align the four screw holes in the camera unit (D) with the screw holes in the ceiling, and then secure the camera in place by tightening the four or more screws (C) through the washers. Remember to use the base gasket.
6. Carry out the settings and adjustments for the camera.
7. Ensure all cable entry points (rear or side) are sealed with silicone sealant to prevent moisture ingress. Failure to observe this may result in condensation deposits that will reduce the IR response of the camera.
8. Secure the dome cover (A) by tightening the screws (B).